

18th Avenue Street Tree Demonstration Site - North

18th Avenue north of Park Street, east side of street

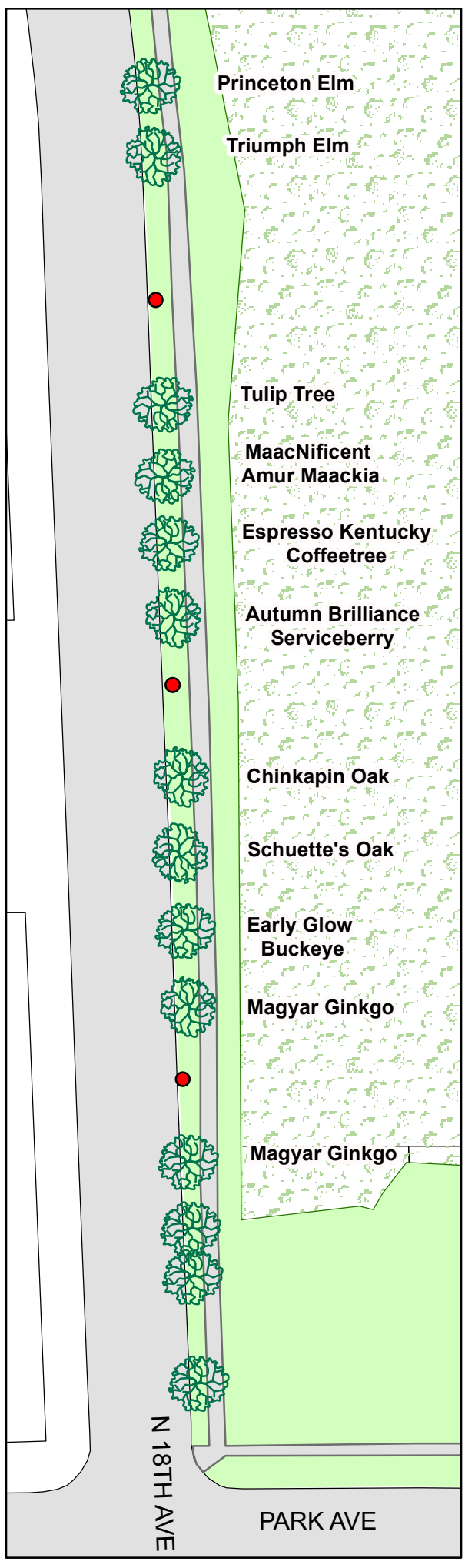

Princeton Elm

Triumph Elm

Tulip Tree

MaacNificent
Amur Maackia

Espresso Kentucky
Coffeetree

Autumn Brilliance
Serviceberry

Chinkapin Oak

Schuette's Oak

Early Glow
Buckeye

Magyar Ginkgo

Magyar Ginkgo

N 18TH AVE

PARK AVE

Princeton Elm *Ulmus americana* 'Princeton'

This American elm cultivar was originally selected in 1922 by New Jersey nurseryman William Flemer of Princeton Nurseries for its aesthetic merit. This cultivar was later found to have moderate resistance to DED but is highly prone to leaf damage by Japanese beetles. This fast growing tree is distinguished by its dense, symmetrical upright form and dark green foliage ultimately forming a broad umbrella crown. Mature height 50-70 ft.

Triumph Elm *Ulmus x wilsoniana x pumila* 'Morton Glossy'

The Triumph elm is a hybrid cultivar raised by the Morton Arboretum in Illinois. The tree was derived from a crossing of two other hybrid cultivars grown at the arboretum; Accolade and Vanguard. Triumph elm has dark green and glossy foliage and a sturdy, straight, symmetrical growth habit. It has very good resistance to DED and is resistant to elm yellows and elm leaf beetle. It is quick to establish, adaptable to most soil types and is easily transplanted. Some years it exhibits yellow fall color. Mature height is 50-60 feet.

Tulip Tree *Liriodendrum tulipifera*

Tulip trees are one of the largest of the native trees of the eastern United States with Wisconsin being on the western edge of its native range. The tree gets its name from the greenish-yellow upright tulip like flowers that bloom in late May through early June. It is fast growing and tends to have a pyramidal crown; this tree prefers deep, rich, and rather moist soil. In ideal conditions, this tree can reach a height of 60' – 90' with a spread of 30'-50'.

MaacNificent Amur Maackia *Maackia amurensis* 'JFS-Schichtel 1'

Amur Maackia is a tough, durable, compact, rounded tree that is adaptable to a wide range of soil conditions and is suitable for smaller landscapes. Compound leaves emerge silvery-green in spring, changing to medium green in summer. Spiky, showy white flowers that are faintly fragrant appear in midsummer when little else is flowering. Mottled olive-green bark adds winter interest. This selection is more vigorous and is a bit more upright and vase shaped in habit than the species. Mature size is 30' high and 22' wide. This is a test tree that is being evaluated for its suitability as a street tree.

Espresso Kentucky Coffeetree *Gymnocladus dioica* 'Espresso'

This tree has interesting bark and large double compound leaves that give it a tropical feel. It is native to the central states of America from Pennsylvania to Nebraska and from Minnesota to Oklahoma. The name comes from early Kentucky settlers because they noticed the resemblance of its seeds to coffee beans. "Espresso" is a male cultivar so it is seedless. In earlier times, Kentucky Coffeetree wood was used in the construction of railway sleeper cars. The arching branches give the tree a vase shape form when mature. Kentucky Coffee trees are medium to slow growers and are tolerant of urban conditions including heat, drought and cold temperatures.

Autumn Brilliance Serviceberry *Amelanchier x grandiflora* 'Autumn Brilliance'

Autumn Brilliance Serviceberry is a hybrid cross between two species of North American serviceberry (downy serviceberry and Allegheny serviceberry). Serviceberry is a small understory tree or tall shrub, usually multi-trunked, which matures to 15'-20' tall. It has white flowers in April followed by edible berries in June which are much coveted by birds. If you are lucky enough to be able to pick the fruit before the birds eat them, they can be used to make jams, jellies or pie filling. The leaves turn red to orange-red in fall. Serviceberry are very hardy and can be grown in full sun to part shade.

See other side of page for information on Chinkapin Oak, Schuette's Oak, Early Glow Buckeye and Magyar Ginkgo

18TH AVENUE STREET TREE DEMONSTRATION SITE NORTH (Continued)

Chinkapin oak (*Quercus muehlenbergii*)

Also referred to as a yellow chestnut oak, rock oak, or yellow oak, the chinkapin oak is a medium to large size oak with glistening dark green leaves in summer turning yellow orange to orangish-brown in fall. Early pioneers used its straight wood to make thousands of miles of fences in the states of Ohio, Kentucky and Indiana. Later on, the trees were used to fuel the steamships that ran from Pittsburgh to New Orleans and were also used as ties for the railroads that crossed the Midwest. The chinkapin oak produces 1" sweet acorns that are at the top of the food preference list for many wildlife species. This tree likes well drained soil but is adaptable to many soil types. Mature size 40'-50' ht. and 50'-60' spread.

Schuettes Oak (*Quercus x schuettei*)

Commonly called Schuettes oak, this tree can be found in the wild as a naturally occurring hybrid between bur oak and swamp white oak. Schuettes oak has glossy green leaves slightly smaller than bur oak leaves that turn a yellowish-brown, sometimes tinged with red in fall. Acorns are abundant and an excellent source of food for wildlife. This oak is best grown in moist, rich, medium soil but is adaptable to a wide range of soil conditions ranging from soggy soils to much drier upland ones. Schuettes oak is not as susceptible to chlorosis as swamp white oak as it can tolerate high pH soil types. Mature height is 50' – 70'.

Early Glow Buckeye – (*Aesculus glabra*)

The Ohio buckeye is a North American native tree native with a range from western Pennsylvania to Iowa south to Alabama and Arkansas. Native Americans reportedly called the fruit of this tree "hetuck" meaning eye-or-the-buck in reference to the supposed resemblance of the shiny dark mahogany brown fruit to the eye of a buck deer. Early Glow™ Buckeye, however, is a seedling selection found by Michael Yanny of Johnson's Nursery in 1981 that produces very few seeds which makes it desirable as a street tree. Early Glow™ buckeye has beautiful yellow-green flowers in spring, early bright red fall color and is a medium sized tree. Mature size is 35' tall and 35' wide.

Magyar Ginkgo (*Ginkgo biloba* 'Magyar')

The ginkgo tree is considered to be a living fossil. It is the only surviving member of a group of ancient plants believed to have inhabited the earth up to 150 million years ago. Ginkgos are dioecious (separate male and female trees) but nurseries typically only sell male trees because the female trees' fruit is messy and gives off a foul odor in autumn when they fall to the ground. 'Magyar' is a male form of ginkgo that was discovered growing in front of Magyar bank in New Brunswick, New Jersey. This tree is slow growing, has a narrow upright form with leaves turning a showy yellow golden color in fall. Mature size is 60' tall and 30' wide.